

User Manual

IP - Android Monitor (Obyn Monitor)

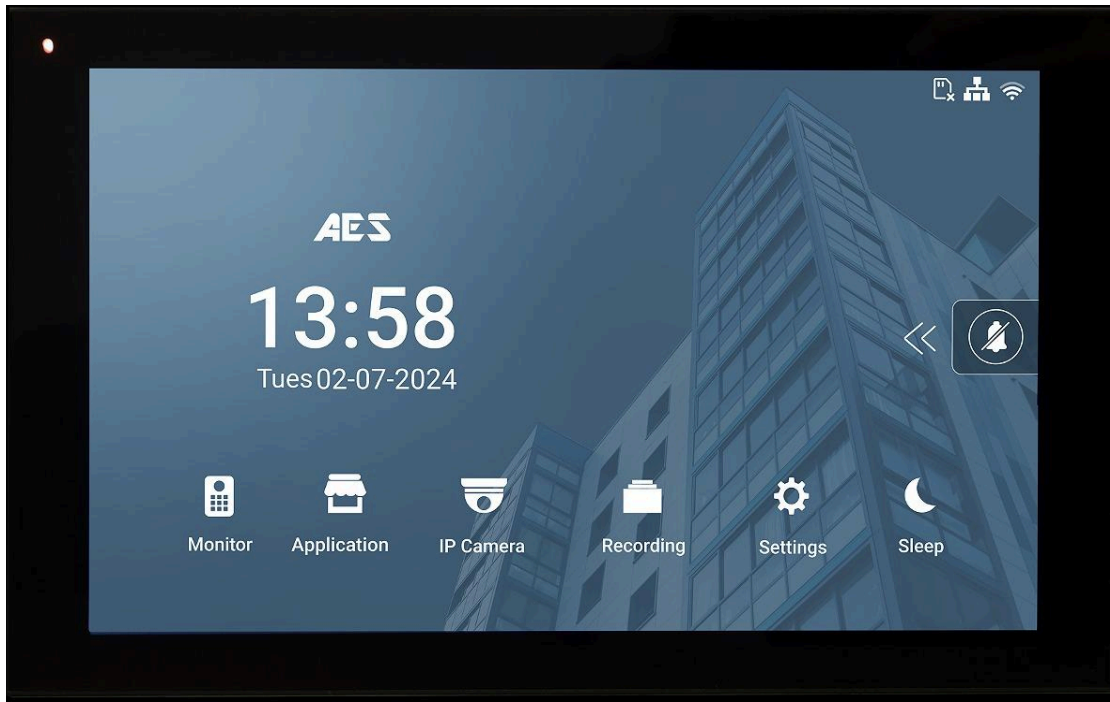

The information in this document may be changed as we always strive to improve the product. Trust that the information provided is accurate at the time of document release.

Technical Specifications	3
Packing Contents	3
Installation & Setup	4
1. Preparation	4
2. Wiring	4
3. Power	4
4. Mounting	5
5. Network Connection	5
Features	7
1. General	7
a. Icons	7
b. Mute	7
c. Image/Video Capture	8
d. Incoming Call	8
2. Monitor	9
3. Application	10
4. IP Camera	11
5. Recording	12
6. Setting	12
a. Common	13
b. WiFi	13
c. Time	14
d. Disturb	14
e. Engineering	15
f. Call Settings	15
7. Sleep	16

Technical Specifications

GENERAL	
Material	Glass & ABS
Approvals	CE-RED, FCC, ROHS
Dimensions	178.6mm (W), 109.6mm (H), 17mm (D) 7in (W), 4.3in (H), 0.6in (D)
Operating Temp	-10 ~ +55
Power Supply	12-15v DC / 48v POE (802.3af)
SD Card Storage	8-128GB
Operating System	Android 12
System	2GB DDR, 16GB FLASH
SCREEN	
Screen Type	7" IPS TFT
Screen Resolution	1024x600
VIDEO	
Video Codec	H.264/H.265
AUDIO	
Audio Streaming	Full duplex with echo cancellation algorithm
Audio Codec	G.711U & G.711A
NETWORK	
WIFI	802.11 b/g/n, 2.4GHz & 5GHz
Ethernet	IEEE 802.3
Supported Protocols	TCP/UDP/RTP/RTSP/HTTP/SIP

Packing Contents

1x Android Monitor
1x Wall Mount Bracket
1x POE Plug
4x Mounting Screws
4x Wall Plugs

Installation & Setup

1. Preparation

Install Preparation



Monitor



POE Plug



Wall Bracket

2. Wiring

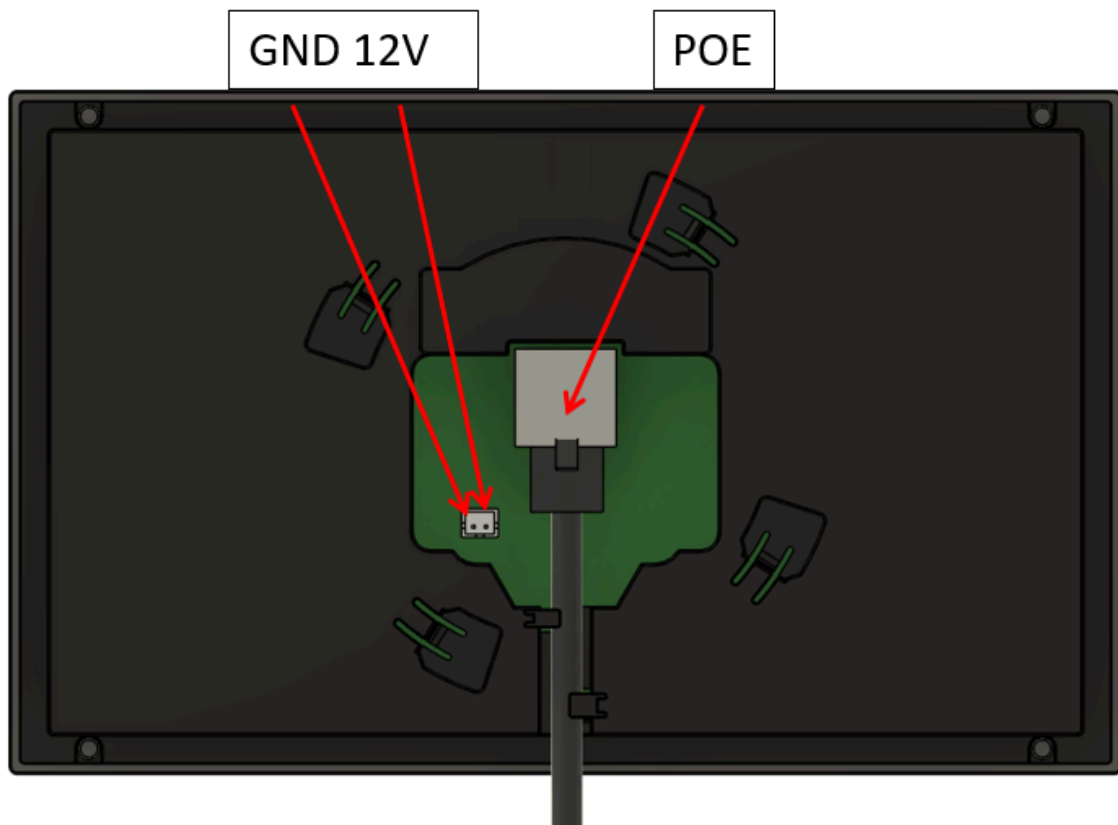

POE - Power-Over-Ethernet, can provide both power and/or network to monitor
GND/12V - DC power option if PoE is not being used.

3. Power

You can power the monitor using the included PoE adapter, which supplies **48V** via the PoE connection. The adapter features two ports: one for Power over Ethernet (PoE) and another for a standard LAN/Ethernet network connection.

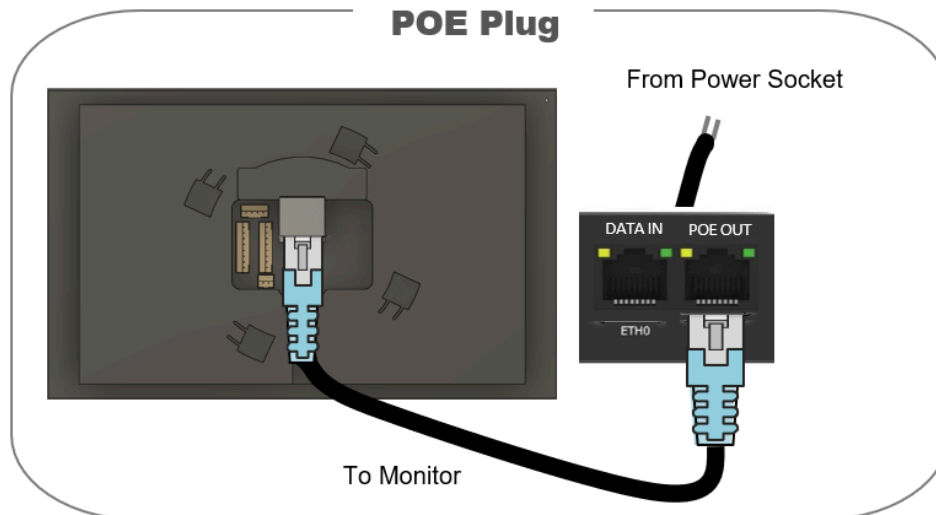

4. Mounting

Wall Mounting

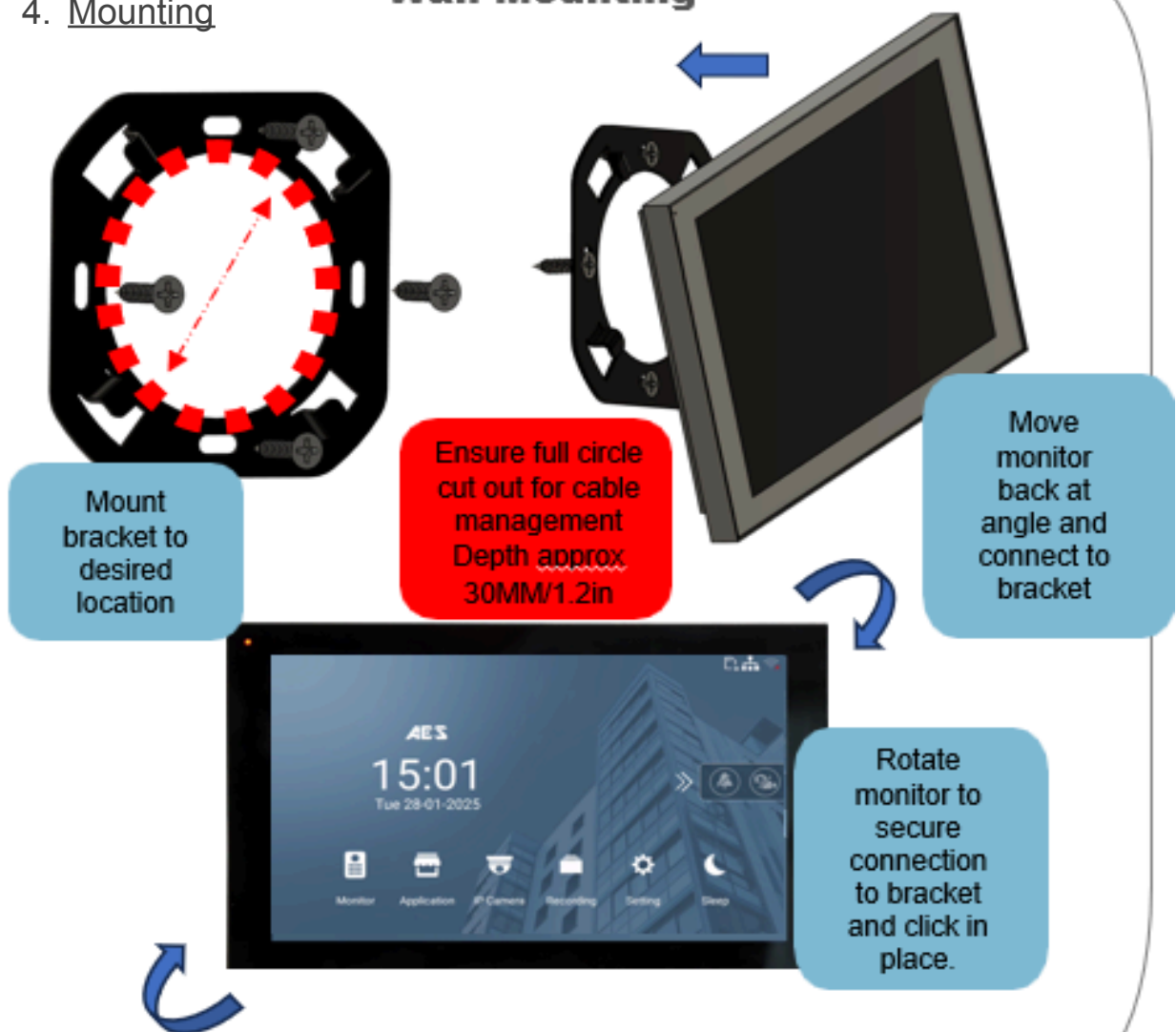

5. Network Connection

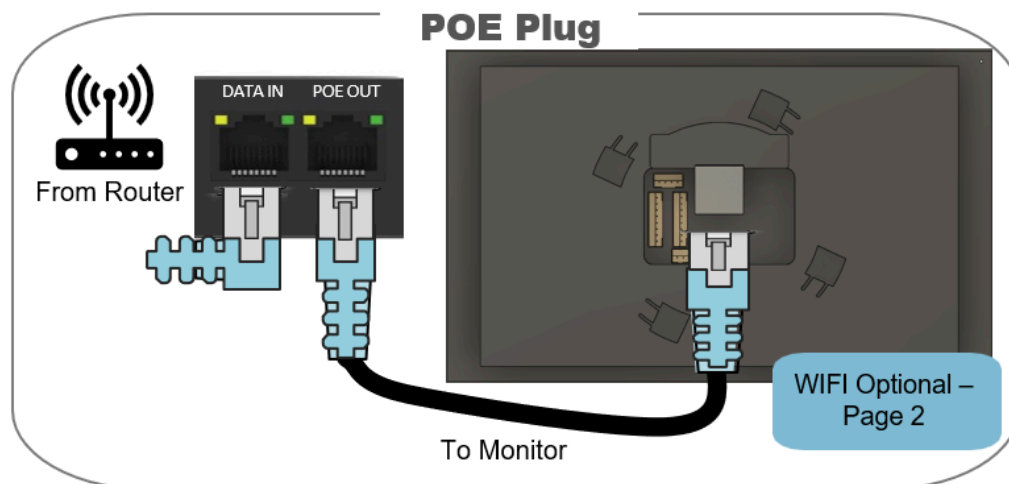

WI-FI CONNECTION

If you don't wish to use Ethernet for network connection, you can use WIFI.

1. Select "SETTING"
2. Select "WIFI"
3. Select "WIFI Config"
4. Select desired network and enter selected password.

Note: Make sure WIFI is toggled ON

Features

1. General

a. Icons

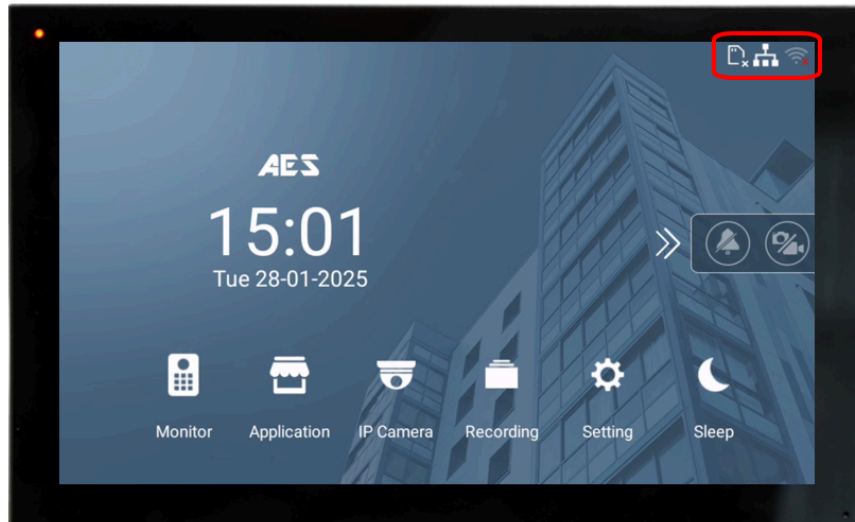

- SD Card. Will appear with or without an “X” depending on if an SD card is inserted or not.



- Ethernet. Will appear with or without an “X” depending on if an Ethernet connection is established or not.



- WIFI. Will appear with or without an “X” depending on if a WIFI connection is established or not.

b. Mute



Disable sound coming from the intercom due notifications & calls

c. Image/Video Capture



Set the monitor to capture a picture, a video or neither upon receiving a call (SIP Call Only)

d. Incoming Call

INCOMING CALL (SIP)

Answer a call made to monitor via SIP

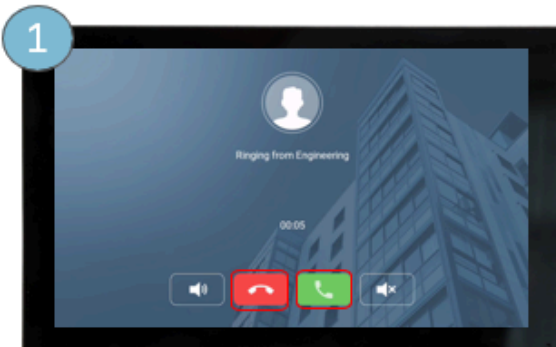

Accept or Decline the call

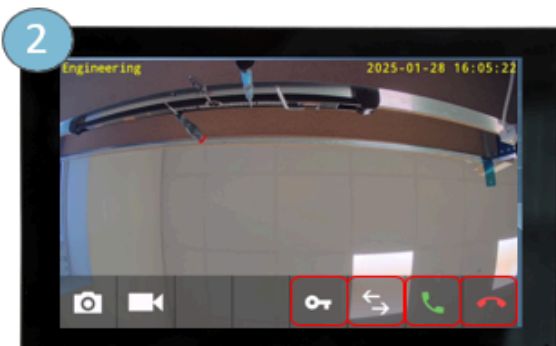

After "Accepting" your key features are:

- Relay Activation** – Click the key icon to see the option of 2 relays to activate.
- 2-Way Speech** – Click the "Green" phone to open communication.
- Exit Call** – Click the "Red" phone to exit the call.

INCOMING CALL (APP)

Answer a call made to monitor via APP



Accept or Decline the call



After "Accepting" your key features are:

- Relay Activation** – Click the lock icon to see the option of 2 relays to activate.
- 2-Way Speech** – Click the microphone to open communication.
- Exit Call** – Click the "arrow" in the top left corner to exit the call.

2. Monitor

ADD INTERCOM (MONITOR)

Add your Opyn intercom to be viewed and controlled without use of the app via P2P

1

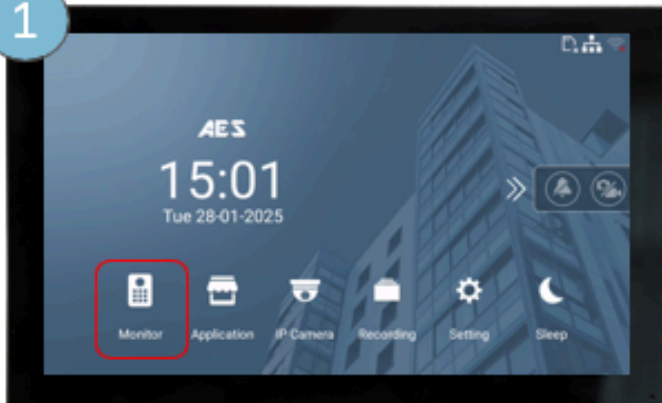

Select "Monitor"

2



Click the "+" icon

3



Enter all relevant information for the Intercom

IP Address: The intercoms IP address.

DTMF: Default for DTMF tones are as seen in photos

Note: Ensure P2P Mode is ticked in the top right corner.

4

Follow the instructions for your device

Opyn: Go to "SIP Configuration" in the mobile app and add the Monitors IP under the P2P Mode.

Opyn Multi: Select the user of the monitor on the management portal. Go to "SIP Settings" and add the Monitors IP under P2P Mode.

5



You can now view your intercom via the monitor and enjoy features such as:

- 2-Way Speech
- Relay Control
- Capture Picture/Video

3. Application

How to access the “AES Opyn” app.

Note: You may also download other apps you may want via the “Google Play Store”.



Power on the monitor and wait for it to finish booting up.



Under "Application" select the "AES Opyn" app.

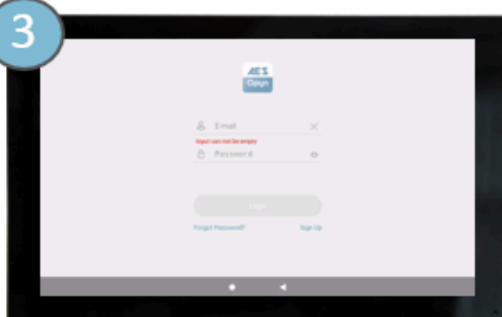

Create an account or login if you already have one.



Scan QR CODE to the OPYN QSG for app instructions.

4. IP Camera

ADD IP CAMERA

1

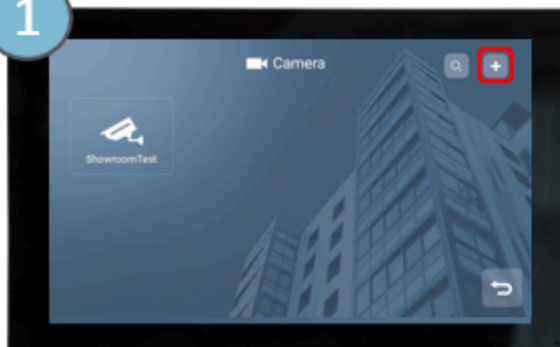

From the home screen click "IP Camera".

Here you can view existing IP cameras or add new ones using the "+" icon.

2



Enter a display name, IP address and login details for the IP Camera.

Then press the green tick to add.

3



- Take snapshots or video recordings of the feed.
- Swap between cameras if you have multiple and
- Exit the view using the icons on the screen.

5. Recording

RECORDING

View Pictures, Videos and Call Records that has been captured using "Monitor" or "IP Camera".



Select "Recording"



In "Picture" see images saved on the Monitor

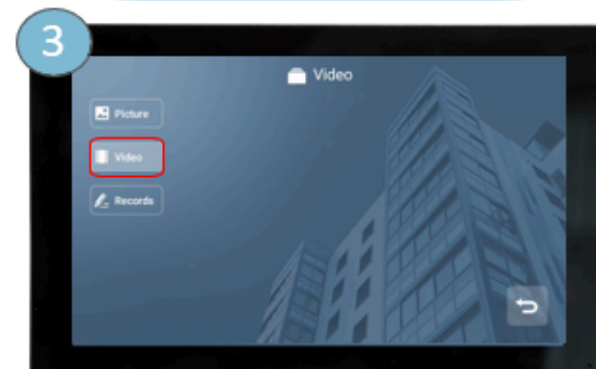

In "Videos" see recordings saved on the Monitor

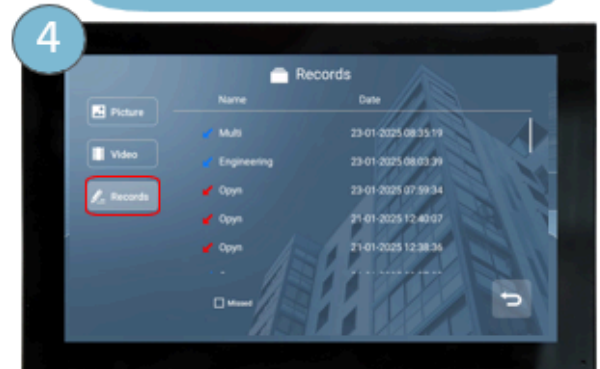

In "Records" call history made using SIP calling from Intercoms.

6. Setting

SETTINGS

Access the monitor settings

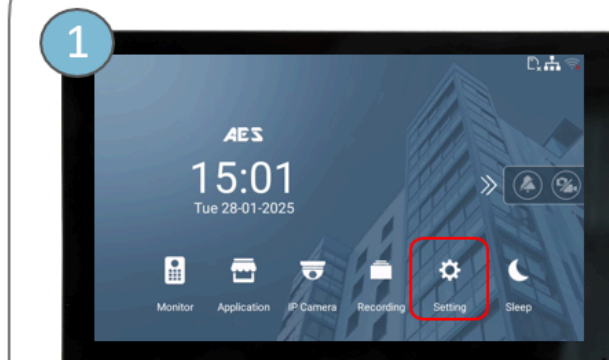

Select "Setting"



You can now see all your settings options

a. Common

**COMMON
(General)**

Access the general settings of the monitor



b. WiFi

WIFI

Access the monitors WIFI settings



c. Time

TIME

Access the monitors TIME settings

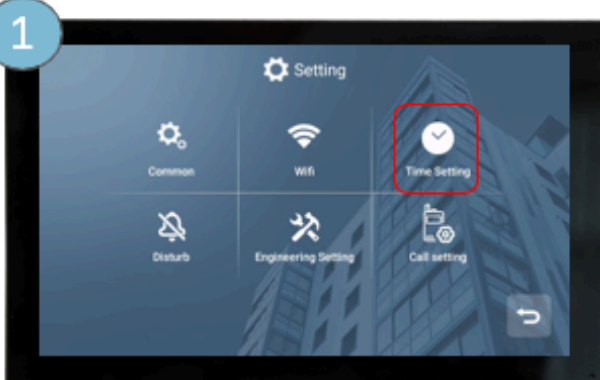

Select "Time Setting"



Enable or Disable NTP Server

Manually Select Time Zone

Set Time Format

d. Disturb

DISTURB

Access the monitors do-not-disturb settings

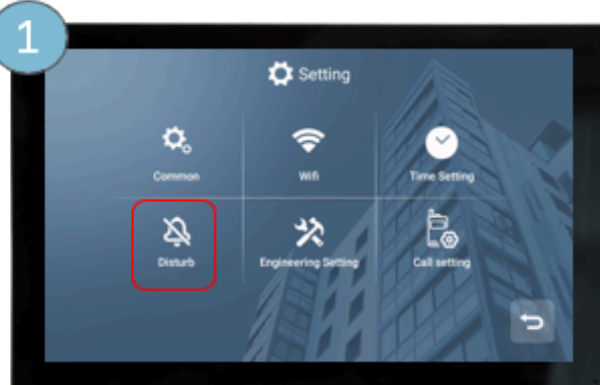

Select "Disturb"



Enable or Disable "Do not Disturb" (DND)

Set up a schedule for when its enabled

e. Engineering

ENGINEERS

Access the monitors engineer's settings

1

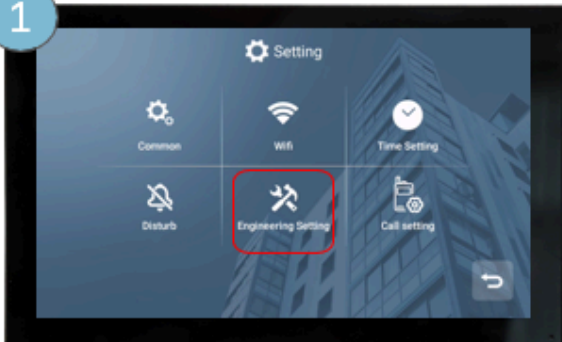

Select "Engineering Setting"

2



System Reset – Factory reset the monitor
PIN – Change the Engineers PIN code.
IP Setting – See the device Ethernet IP address.
SIP Account – Configure SIP account.

f. Call Settings

CALL SETTINGS

Access the call settings of the monitor

1



Select "CALL SETTING"

2



You can now see all the settings options

3



Navigate to the 2nd page to see the remaining options

7. Sleep

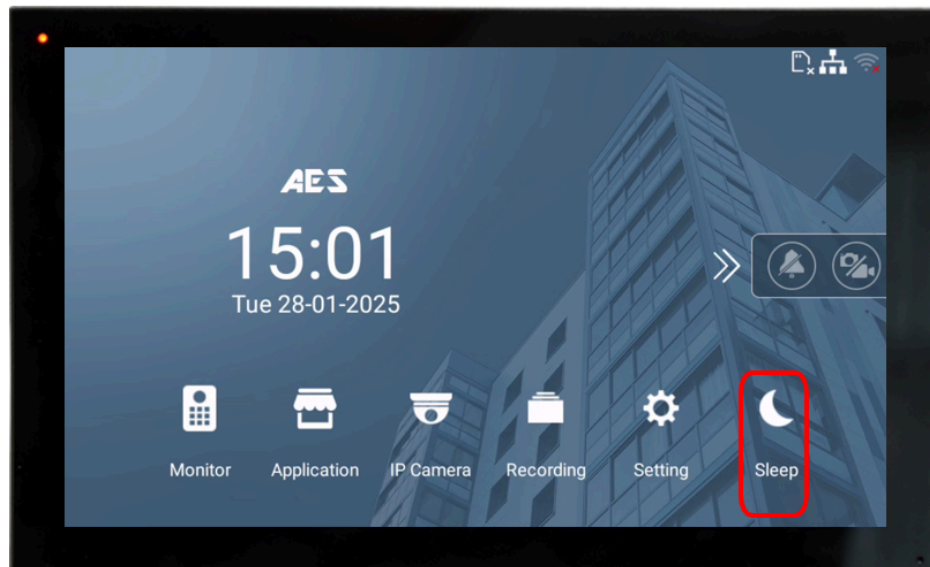

Will put the monitor into sleep mode. Turning off the screen while the monitor is running in the background. You will still be able to receive calls and notifications.

Warranty

Please note, by installing this product, you are accepting our warranty terms. This warranty is a “return to base” 2-year manufacturer’s warranty.

For full warranty terms and conditions contact the AES Technical Support Team



sales@aesglobalonline.com
technical@aesglobalonline.com
TEL: +44 (0) 288 6390 693

www.aesglobalonline.com



sales@aesglobalus.com
technical@aesglobalus.com
TEL: +1 (321) 900 4599

www.aesglobalus.com



support@aesglobaltelecom.com
TEL UK-EU: +44 (0) 288 6390 693
TEL USA: +1 (321) 900 4599

www.aesglobaltelecom.com