

I Copricolonna quadro grezzo con bordo

UK Welding square cap with flanges - black



D Anschweißbare Abdeckkappen, roh

F Chapeau noir avec bords à souder sur tube carré

E Cubrecolumna cuadrada non cincado

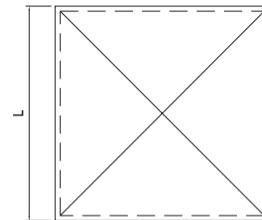
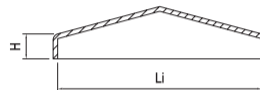
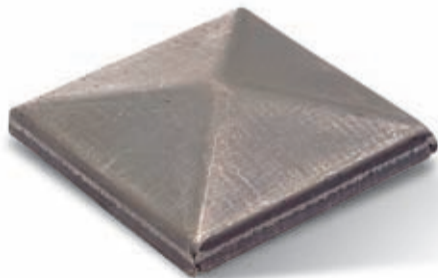
RUS Крышка черный металл под сварку на квадратную трубу



Articolo - Article		L	Li	H		
Riferimento - Reference				mm	N°	
CAP 3G	PG 30 07 QX	35	31	7	100	3,1
CAP 4G	PG 40 07 QX	45	41	7	100	4,7
CAP 5G	PG 50 08 QX	55	51	7	50	3,3
CAP 6G	PG 60 08 QX	65	61	7	50	4,3
CAP 8G	PG 80 08 QX	85	81	7	50	7
CAP 10G	PG 10 09 QX	105	101	7	50	10,3
CAP 12G	PG 12 11 QX	125	121	8	20	5,5
CAP 15G	PG 15 12 QX	155	151	9	10	4,3
CAP 20G	PG 20 14 QX	205	201	10	8	7,6

I Copricolonna quadro zincato con bordo

- UK Welding square cap with flanges - galvanised
- D Anschweißbare Abdeckkappen, gelb verzinkt
- F Chapeau zingué avec bords à souder sur tube carré
- E Cubrecolumna cuadrada cincado
- RUS Крышка оцинк под сварку на квадратную трубу

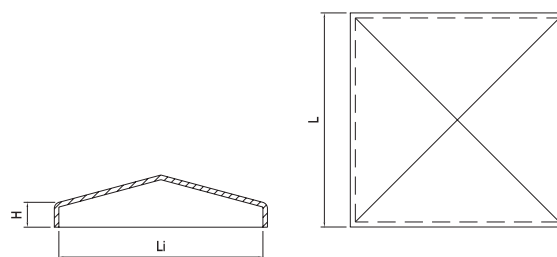

Articolo - Article		L	Li	H		
Riferimento - Reference		□		mm	N°	⊕
CAP 3Z	PZ 30 07 QO	35	31	7	100	3,1
CAP 4Z	PZ 40 07 QO	45	41	7	100	4,7
CAP 5Z	PZ 50 08 QO	55	51	7	50	3,3
CAP 6Z	PZ 60 08 QO	65	61	7	50	4,3
CAP 8Z	PZ 80 08 QO	85	81	7	50	7
CAP 10Z	PZ 10 09 QO	105	101	7	50	10,3
CAP 12Z	PZ 12 11 QO	125	121	8	20	5,5
CAP 15Z	PZ 15 12 QO	155	151	9	10	4,3
CAP 20Z	PZ 20 14 QO	205	201	10	8	7,6

I Copricolonna rettangolare grezzo con bordo

- UK Welding rectangular cap with flange - black
- D Anschweißbare Abdeckkappen mit flansch fuer Rechteckrohre, roh
- F Chapeau noir avec bords à souder sur tube rectangulaire
- E Cubrecolumna rectangular non cincado
- RUS Крышка нержавеющей под сварку на квадратную трубу

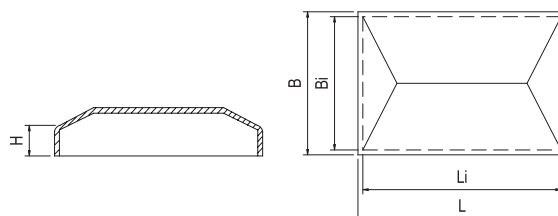
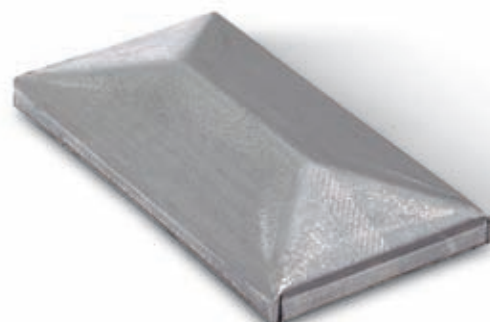

Articolo - Article		L	Li	B	Bi	H		
Riferimento - Reference		□				mm	N°	⊕
CAP 1RG	PG 20 30 RX	34	31	24	21	7	200	3,8
CAP 2RG	PG 20 40 RX	44	41	24	21	7	200	4,6
CAP 3RG	PG 30 50 RX	54	51	34	31	7	100	3,2
CAP 4RG	PG 30 60 RX	64	61	34	31	7	100	3,7
CAP 5RG	PG 40 60 RX	64	61	44	41	7	100	5,1
CAP 6RG	PG 40 80 RX	84	81	44	41	7	50	3,4
CAP 7RG	PG 50 10 RX	104	101	54	51	7	40	3,5

I Copricolonna tondo grezzo con bordo

- UK Welding round cap with flange - black
- D Anschweißbare Rundekappen mit flansch, roh
- F Chapeau noir avec bords à souder sur tube rond
- E Cubrecolumna circular non cincado
- RUS Крышка из черного металла под сварку на прямоугольную трубу

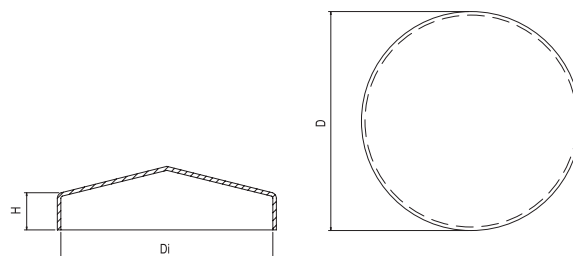



Articolo - Article		D	Di	H		
Riferimento - Reference		⊙		mm	N°	⊕
CAP 1TG	PG 30 11 TX	33	30	10	200	4,6
CAP 2TG	PG 33 11 TX	36	33	10	200	4,7
CAP 3TG	PG 42 11 TX	45	42	10	100	3,9
CAP 4TG	PG 48 13 TX	51	48	10	100	4,8
CAP 5TG	PG 60 14 TX	63	60	10	50	3,6
CAP 6TG	PG 76 14 TX	79	76	14	30	3,0
CAP 7TG	PG 90 14 TX	92	90	14	20	2,6
CAP 8TG	PG 11 14 TX	104	101	14	20	3,0
CAP 9TG	PG 12 14 TX	117	114	14	20	3,8

Cardini

I Copricolonna a sfera in acciaio cromato

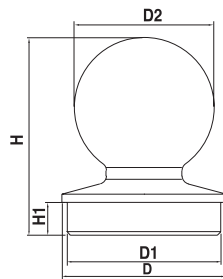
- UK Spherical cap in chromated steel
D Anschweißbare Abdeckkappe in Kugelform verchromt
F Chapeau à sphère en acier chromé
E Cubrecolumna esférica en acero cromato
RUS Наконечник сферический из хромированной стали



Articolo - Article		D	D1	D2	H	H1	
Riferimento - Reference			∅		mm		N° 
SF 60	PC 60 85 00	60	56,5	50	85	20	5 5,5
SF 76	PC 76 95 00	76	71	65	95	20	4 8
SF 102	PC 10 12 00	102	97	90	120	20	2 9,5